

EVENT VENUES



Village Conference Centre



Atrium



Courtyard



The Courts



Huron Grand Ballroom

VILLAGE CONFERENCE CENTRE

The Village Conference Centre has expanded with a new 11,375 square foot multi-purpose facility designed to highlight the natural beauty of the surrounding area — a truly inspirational conference setting! This conference centre contains a main meeting space that can be divided into four and used for junior meetings, breakout sessions or dining.

The Courts comprise a 23,000 square foot barrier-free space that can transform into a state-of-the-art convention, special event or trade show area.

Impressive outdoor spaces, including beautifully landscaped decks, patios and walkways overlooking Monterra Golf and the Blue Mountain Village, will further delight guests.

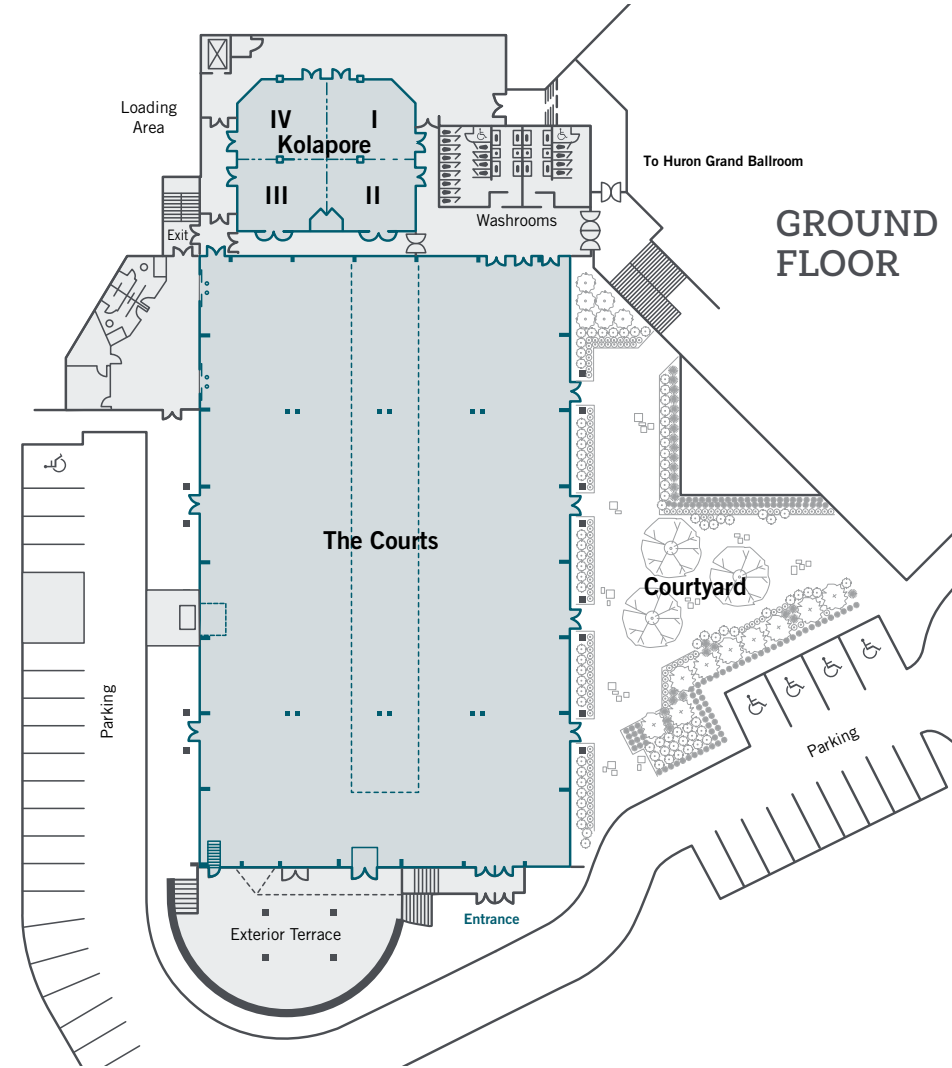

VILLAGE CONFERENCE CENTRE

Visually stunning, the Conference Centre features breathtaking views of the mountain and Georgian Bay. This state-of-the-art facility is located steps away from all accommodation, dining and shopping areas of the Blue Mountain Village, the mountain slopes and the fairways of Monterra Golf. The facility's interior brings the beauty of the outdoors in, featuring high ceilings with enormous beams, rustic open trussing and floor-to-ceiling windows.

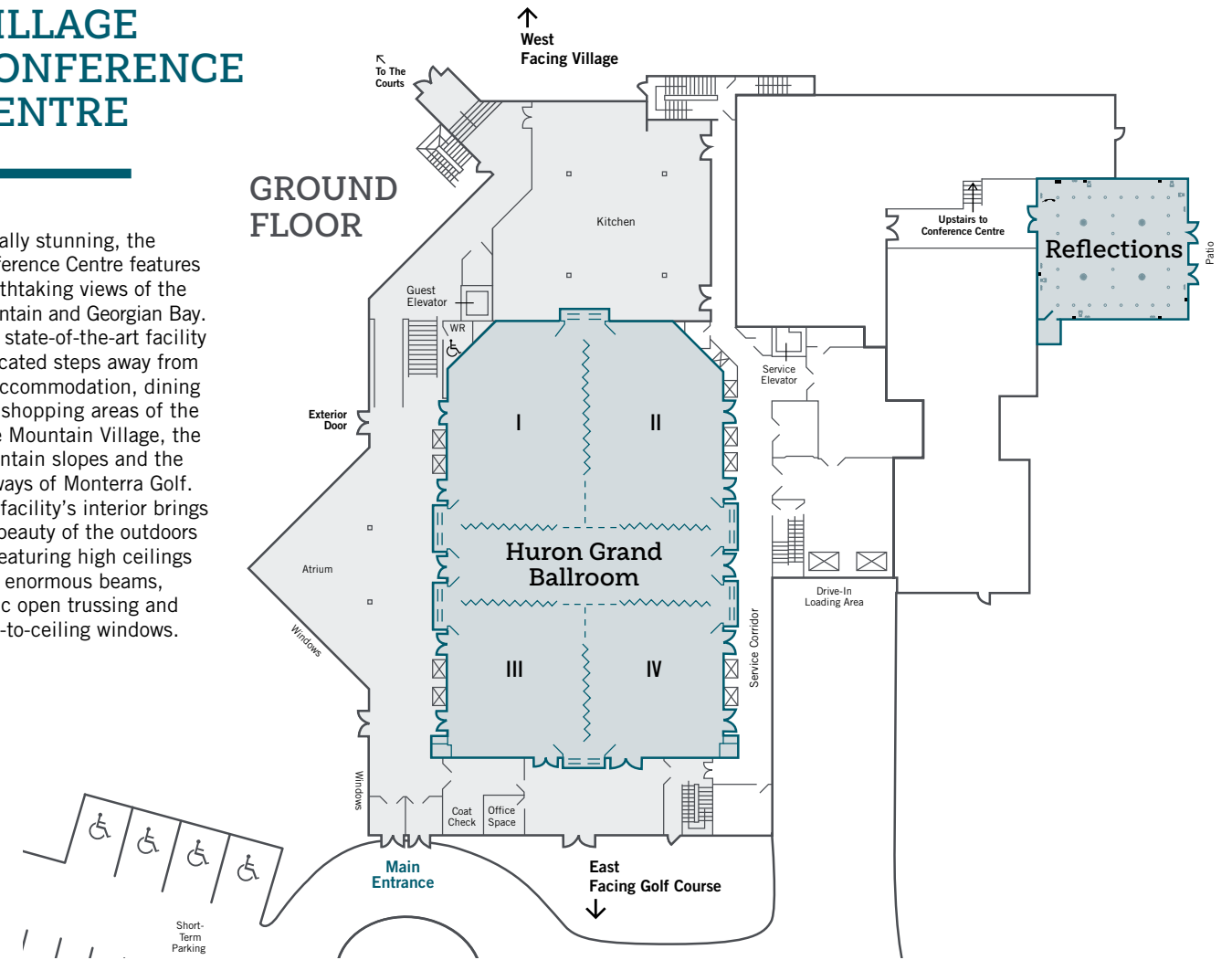

VILLAGE CONFERENCE CENTRE - GROUND FLOOR

CONFERENCE ROOM	SIZE	SQUARE FEET	HEIGHT	CLASSROOM	THEATRE	BANQUET 8	HALF ROUNDS 6	HOLLOW SQUARE	U-SHAPED	8' X 10' BOOTHS	10' X 10' BOOTHS
The Courts	196' x 119'	23,324	34.5'	1,320	1,650	1,584	1,188	n/a	n/a	•	100
Courts Terrace	•	2,980	•	n/a	n/a	n/a	n/a	n/a	n/a	n/a	•
Kolapore	49' x 56'	2,744	8' 2"	64	150	160	96	40	32	•	•
Kolapore I	24.5' x 28'	686	8' 2"	32	60	32	30	24	20	•	•
Kolapore II	24.5' x 28'	686	8' 2"	32	50	32	24	24	20	•	•
Kolapore III	24.5' x 28'	686	8' 2"	32	40	32	24	24	24	•	•
Kolapore IV	24.5' x 28'	686	8' 2"	32	60	32	24	24	20	•	•
Kolapore I & IV	49' x 28'	1,372	8' 2"	64	130	80	60	40	36	•	•
Kolapore II & III	49' x 28'	1,372	8' 2"	64	90	72	54	40	32	•	•

Numbers in these charts are estimates based on maximum capacity. Audio visual requirements have not been accounted for in these numbers.

VILLAGE CONFERENCE CENTRE - GROUND FLOOR

CONFERENCE ROOM	SIZE	SQUARE FEET	HEIGHT	CLASSROOM (ROWS OF 4)	THEATRE	BANQUET 8	HALF ROUNDS 6	HOLLOW SQUARE	U-SHAPED	BOARD ROOM
Huron Grand Ballroom	114' x 75'	8524	15'	532	1000	600	420	•	•	•
Huron Grand Ballroom I	37' x 53'	1,948	15'	96	216	120	90	56	44	•
Huron Grand Ballroom II	37' x 53'	1,948	15'	96	216	120	90	56	44	•
Huron Grand Ballroom I & II	75' x 53'	3,975	15'	224	432	224	210	88	76	•
Huron Grand Ballroom III	37.5' x 39.5'	1,481	15'	80	144	72	54	48	36	•
Huron Grand Ballroom IV	37.5' x 39.6'	1,481	15'	80	144	72	54	48	36	•
Huron Grand Ballroom III & IV	75' x 53'	3,975	15'	208	300	160	108	88	72	•
Reflections	38' x 38'	1,453	8.6'	80	128	112	84	48	36	•
Atrium	105' x 20'	2,800	•	•	•	•	•	•	•	•

Numbers in these charts are estimates based on maximum capacity. Audio visual requirements have not been accounted for in these numbers.



Petun



Village Conference Centre



Petun



The Courts



Nipissing

VILLAGE CONFERENCE CENTRE

MEZZANINE LEVEL

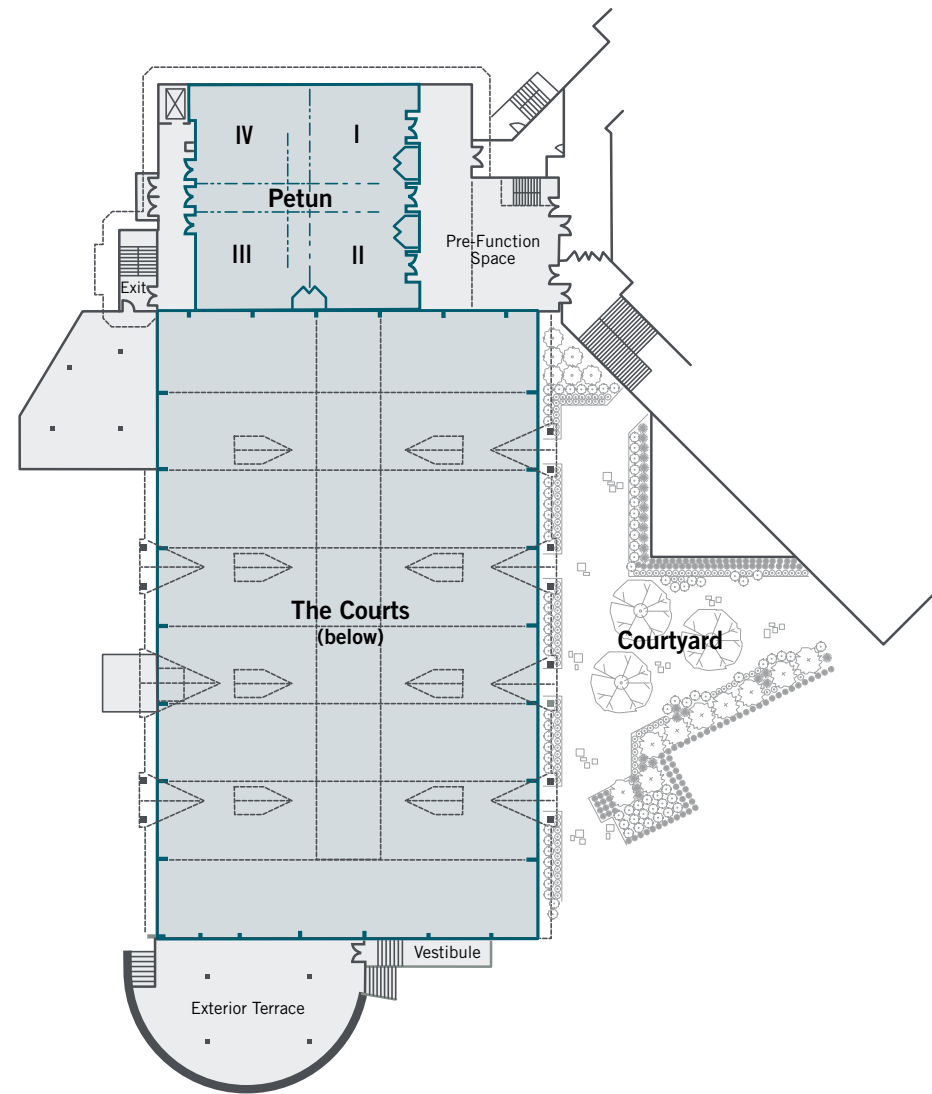

VILLAGE CONFERENCE CENTRE

MEZZANINE LEVEL

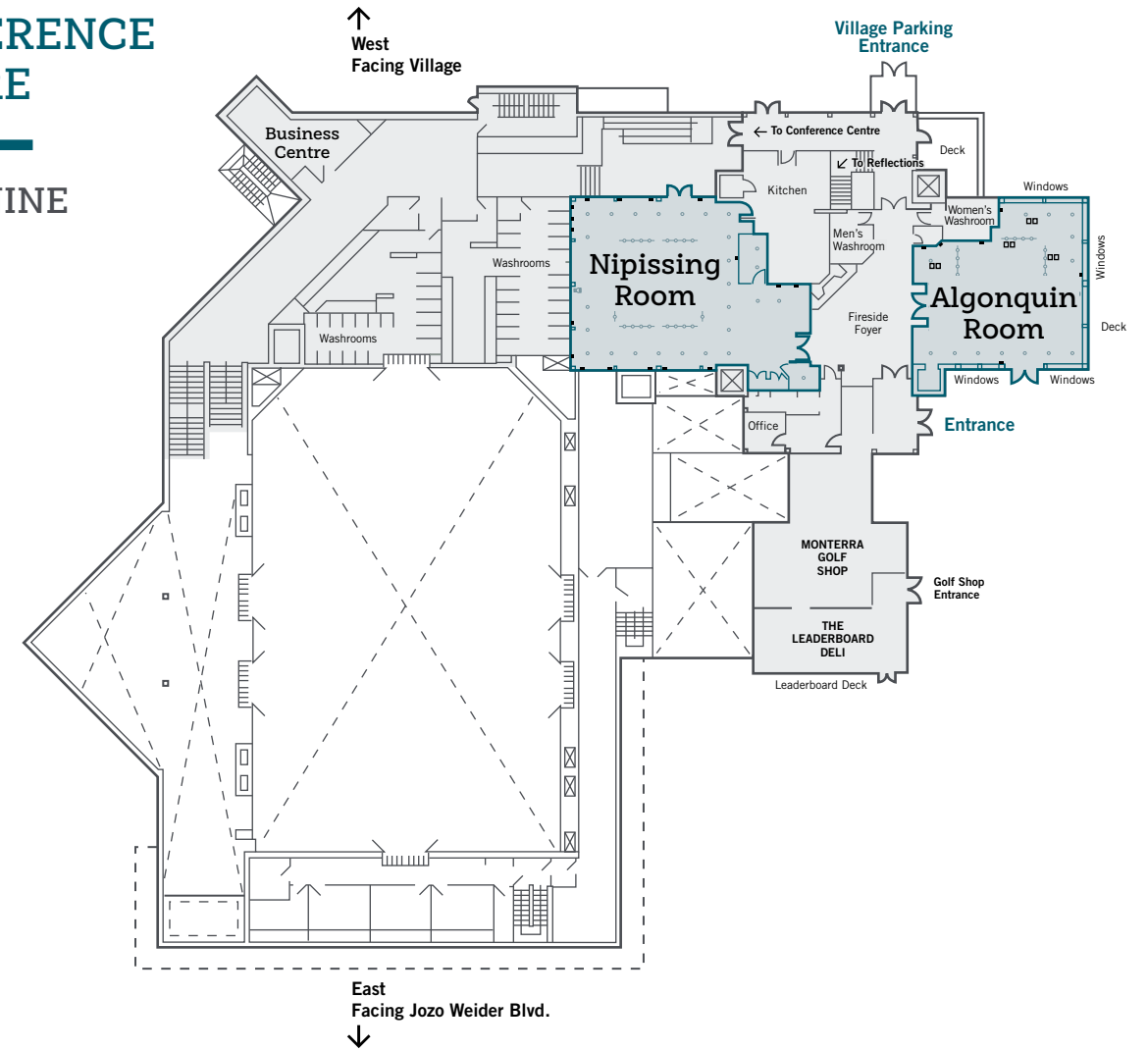

VILLAGE CONFERENCE CENTRE - MEZZANINE LEVEL

CONFERENCE ROOM	SIZE	SQUARE FEET	HEIGHT	CLASSROOM	THEATRE	BANQUET 8	HALF ROUNDS 6	HOLLOW SQUARE	U-SHAPED	8' X 10' BOOTHS	10' X 10' BOOTHS
Petun	65' x 70'	4,550	14' 6"	240	450	320	216	152	152	26	•
Petun I	32.5' x 35'	1,137	14' 6"	44	84	64	48	40	32	•	•
Petun II	32.5' x 35'	1,137	14' 6"	44	84	72	40	32	28	•	•
Petun III	32.5' x 35'	1,137	14' 6"	44	84	64	48	40	32	•	•
Petun IV	32.5' x 35'	1,137	14' 6"	44	72	72	48	40	32	•	•
Petun I & IV	65' x 35'	2,274	14' 6"	132	168	144	108	64	56	•	•
Petun II & III	65' x 35'	2,274	14' 6"	116	160	128	96	64	56	•	•

Numbers in these charts are estimates based on maximum capacity. Audio visual requirements have not been accounted for in these numbers.

VILLAGE CONFERENCE CENTRE - MEZZANINE LEVEL

CONFERENCE ROOM	SIZE	SQUARE FEET	HEIGHT	CLASSROOM (ROWS OF 4)	THEATRE	BANQUET 8	HALF ROUNDS 6	HOLLOW SQUARE	U-SHAPED	BOARD ROOM
Algonquin	38' x 29'	1,222	9.6'	52	120	104	72	40	32	•
Nipissing	39' x 37'	1,686	9.6'	92	158	104	84	48	38	•

Numbers in these charts are estimates based on maximum capacity. Audio visual requirements have not been accounted for in these numbers.



Silver Creek



Georgian Bay Ballroom



The Westin Trillium House



Panorama Foyer



Blackcomb

VILLAGE CONFERENCE CENTRE

THIRD FLOOR

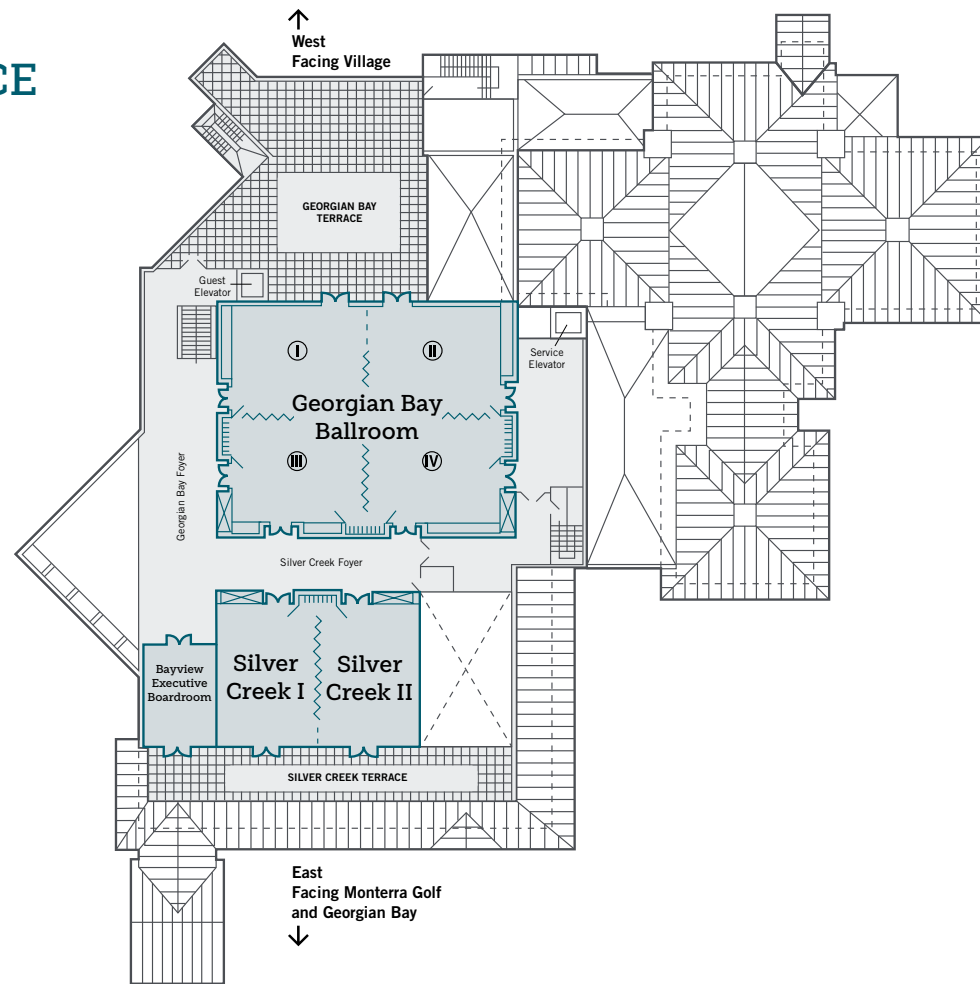

THE WESTIN TRILLIUM HOUSE, BLUE MOUNTAIN

The Westin Trillium House, Blue Mountain, offers a relaxing retreat for conferences of different sizes and a tranquil oasis during any season. For your next meeting or business event, take advantage of over 7,000 square feet of versatile space and our state-of-the-art conference facilities. Venues include two ballrooms and a stunning pre-function area with its own private outdoor terrace overlooking a creek and waterfall.

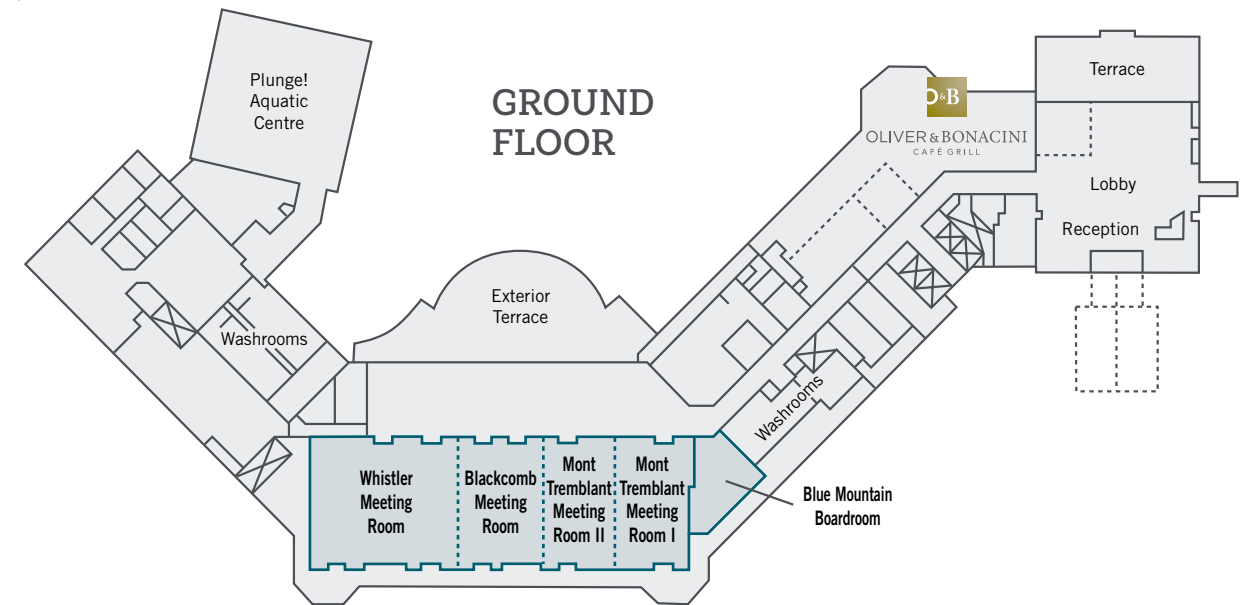

VILLAGE CONFERENCE CENTRE - THIRD FLOOR

CONFERENCE ROOM	SIZE	SQUARE FEET	HEIGHT	CLASSROOM (ROWS OF 4)	THEATRE	BANQUET 8	HALF ROUNDS 6	HOLLOW SQUARE	U-SHAPED	BOARD ROOM
Georgian Bay Ballroom	70' x 56.5'	3,962	12'	280	420	288	216	88	72	25
Georgian Bay Ballroom I	35' x 28'	980	12'	60	100	72	48	40	32	25
Georgian Bay Ballroom II	35' x 28'	980	12'	60	100	72	48	40	32	25
Georgian Bay Ballroom I & II	70' x 28'	1,960	12'	132	192	144	108	72	64	50
Georgian Bay Ballroom III	35' x 28'	980	12'	60	100	72	48	40	32	25
Georgian Bay Ballroom IV	35' x 28'	980	12'	60	100	72	48	40	32	25
Georgian Bay Ballroom III & IV	70' x 28'	1,960	12'	132	192	144	108	72	64	50
Bayview Executive Boardroom	25.5' x 18.5'	485	12'	•	•	•	•	•	•	14
Silver Creek	51' x 36'	1,880	12'	104	234	160	102	64	52	25
Silver Creek I	26' x 36'	936	12'	48	96	64	54	40	32	25
Silver Creek II	26' x 36'	936	12'	48	96	64	54	40	32	25

Numbers in these charts are estimates based on maximum capacity. Audio visual requirements have not been accounted for in these numbers.

THE WESTIN TRILLIUM HOUSE, BLUE MOUNTAIN CONFERENCE FACILITIES - GROUND FLOOR

CONFERENCE ROOM	SIZE	SQUARE FEET	HEIGHT	RECEPTION	CLASSROOM (ROWS OF 4)	THEATRE	BANQUET 8	HALF ROUNDS 6	HOLLOW SQUARE	U-SHAPED
Panorama Foyer	130' x 25'	3,302	12'	300	•	•	•	•	•	•
Whistler/Blackcomb/Tremblant*	142' x 44'	6,336	12'	600	•	•	•	376	•	•
Whistler/Blackcomb Ballroom	88' x 44'	3,872	12'	350	180	500	270	180	•	•
Whistler Meeting Room	56' x 44'	2,464	12'	200	110	280	120	120	•	66
Blackcomb Meeting Room	32' x 44'	1,408	12'	120	72	144	90	72	50	40
Mont Tremblant Meeting Room	54' x 44'	2,376	12'	238	120	240	180	110	•	60
Mont Tremblant I Meeting Room	27' x 44'	1,188	12'	119	60	120	70	55	40	36
Mont Tremblant II Meeting Room	27' x 44'	1,188	12'	119	60	120	70	55	40	36
The Mill Pond Terrace	IRREGULAR	2,287	ENDLESS	150	•	•	100	96	•	•
Blue Mountain Boardroom	IRREGULAR	450	12'	30	27	40	24	•	12	14

Numbers in these charts are estimates based on maximum capacity. Audio visual requirements have not been accounted for in these numbers.

*Whistler/Blackcomb Rooms open to Mont Tremblant Room by three sets of double doors in a permanent wall.



Blue Mountain Inn Conference Centre



Kandahar



Weider



Inn Café

BLUE MOUNTAIN INN CONFERENCE CENTRE

Situated at the base of the slopes, this beautifully designed centre offers guests state-of-the-art technology within scenic and comfortable surroundings. The conference centre also provides convenient indoor travel from the Blue Mountain Inn's 98 rooms to all the centre's meeting spaces.

BLUE MOUNTAIN INN CONFERENCE CENTRE FEATURES

- Three spacious meeting rooms – Weider I, II and III
- Pre-function room (Kandahar) with floor-to-ceiling windows and a gas fireplace
- Spacious outdoor terrace
- Business centre
- Six breakout rooms on the lower level
- Linked to the Blue Mountain Village by a pedestrian walkway
- All meeting rooms are located within the Blue Mountain Inn, allowing for easy interior travel

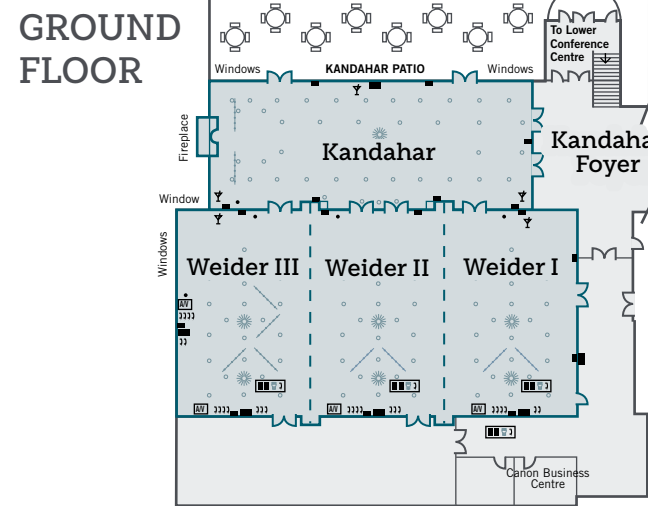
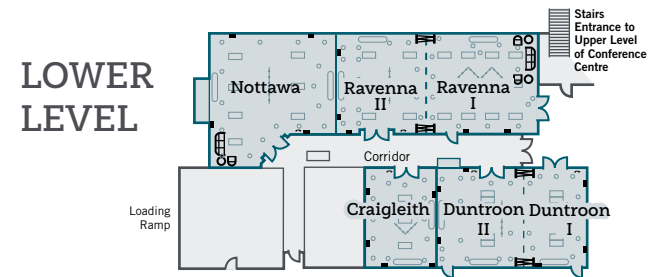

SECOND LEVEL

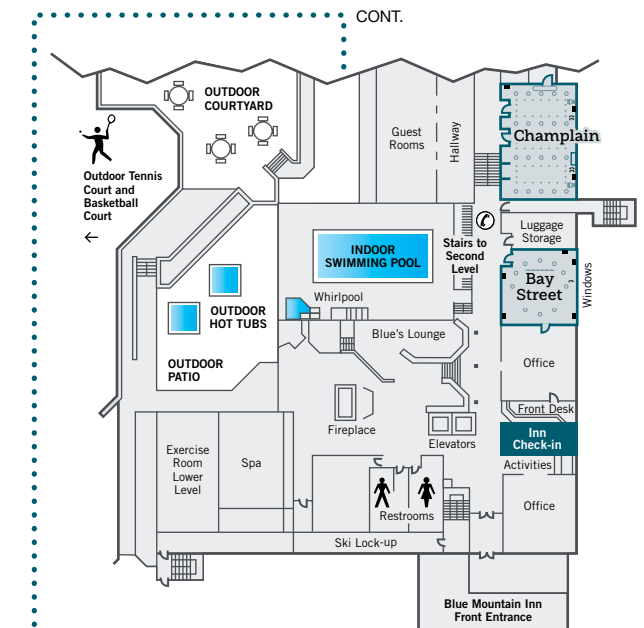
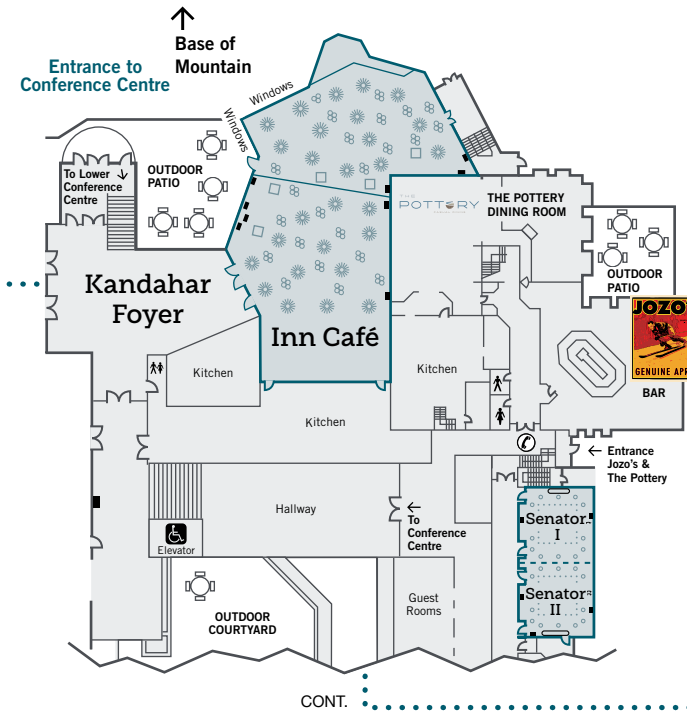
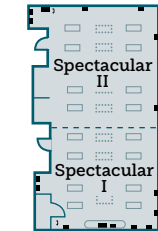

BLUE MOUNTAIN INN CONFERENCE CENTRE - GROUND FLOOR & LOWER LEVEL

CONFERENCE ROOM	SIZE	SQUARE FEET	HEIGHT	CLASSROOM (ROWS OF 4)	THEATRE	BANQUET 8	HALF ROUNDS 6	HOLLOW SQUARE	U-SHAPED	BOARD ROOM
Kandahar	86.5' x 32'	2,768	13.3'	168	266	184	120	64 long	56 long	•
The Weider Room	108.5' x 54.5'	5,913	14'	400	700	400	300	•	•	•
Weider I	36' x 54.5'	1,962	14'	128	234	120	90	56 long	48 long	•
Weider II	36' x 54.5'	1,962	14'	128	234	120	90	56 long	48 long	•
Weider III	36' x 54.5'	1,962	14'	128	234	120	90	56 long	48 long	•
Nottawa	33' x 26'	978	7'	40	80	56	42	36	28	25
Ravenna	53.5' x 24'	1,286	7'	64	110	88	60	48	44	25
Ravenna I	30' x 24'	720	7'	36	60	40	36	32	28	25
Ravenna II	23.5' x 24'	564	7'	24	48	32	24	24	20	25
Craigleith	25.5' x 18'	459	7'	24	40	16	18	16	12	25
Duntroon	39' x 25'	975	7'	48	88	64	48	32	28	25
Duntroon I	16' x 25'	400	7'	16	40	24	18	16	16	16
Duntroon II	22.5' x 25'	563	7'	24	48	32	24	24	20	25

Numbers in these charts are estimates based on maximum capacity. Audio visual requirements have not been accounted for in these numbers.

BLUE MOUNTAIN INN CONFERENCE CENTRE - GROUND FLOOR & SECOND LEVEL

CONFERENCE ROOM	SIZE	SQUARE FEET	HEIGHT	CLASSROOM (ROWS OF 4)	THEATRE	BANQUET 8	HALF ROUNDS 6	HOLLOW SQUARE	U-SHAPED	BOARD ROOM
Spectacular	22' x 45'	990	8'	56	96	56	60	40 long	28 long	25
Spectacular I	22' x 24.5'	440	8'	24	36	24	24	16	16	25
Spectacular II	22' x 20'	539	8'	32	45	32	36	20	20	20
Champlain	22' x 37'	822	8'	40	75	48	36	36	30	25
Senator	22' x 49'	1,117	8'	64	108	80	60	44 long	38 long	•
Senator I	22' x 24'	528	8'	28	45	32	30	24	22	25
Senator II	22' x 24'	528	8'	28	45	32	30	24	22	25
Bay Street	24' x 23.5'	564	8'	24	50	32	30	28	20	25
Inn Café	55.5' x 75'	4,166	9.5'	120	400	280	210	62	50	•

Numbers in these charts are estimates based on maximum capacity. Audio visual requirements have not been accounted for in these numbers.